

Do not count birds NE of this corner

Lykins Gulch Route:  
from here to Hwy. 36;  
use separate map

# South Rabbit Mountain Survey Route



**LEGEND**

- BCNA Raptor Survey Route
- 500m GRID

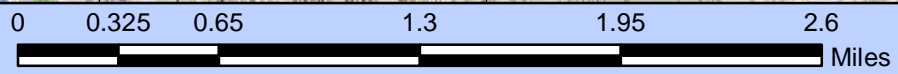

Coordinate System: NAD 1983 HARN StatePlane Colorado North FIPS 0501  
Datum: North American 1983 HARN



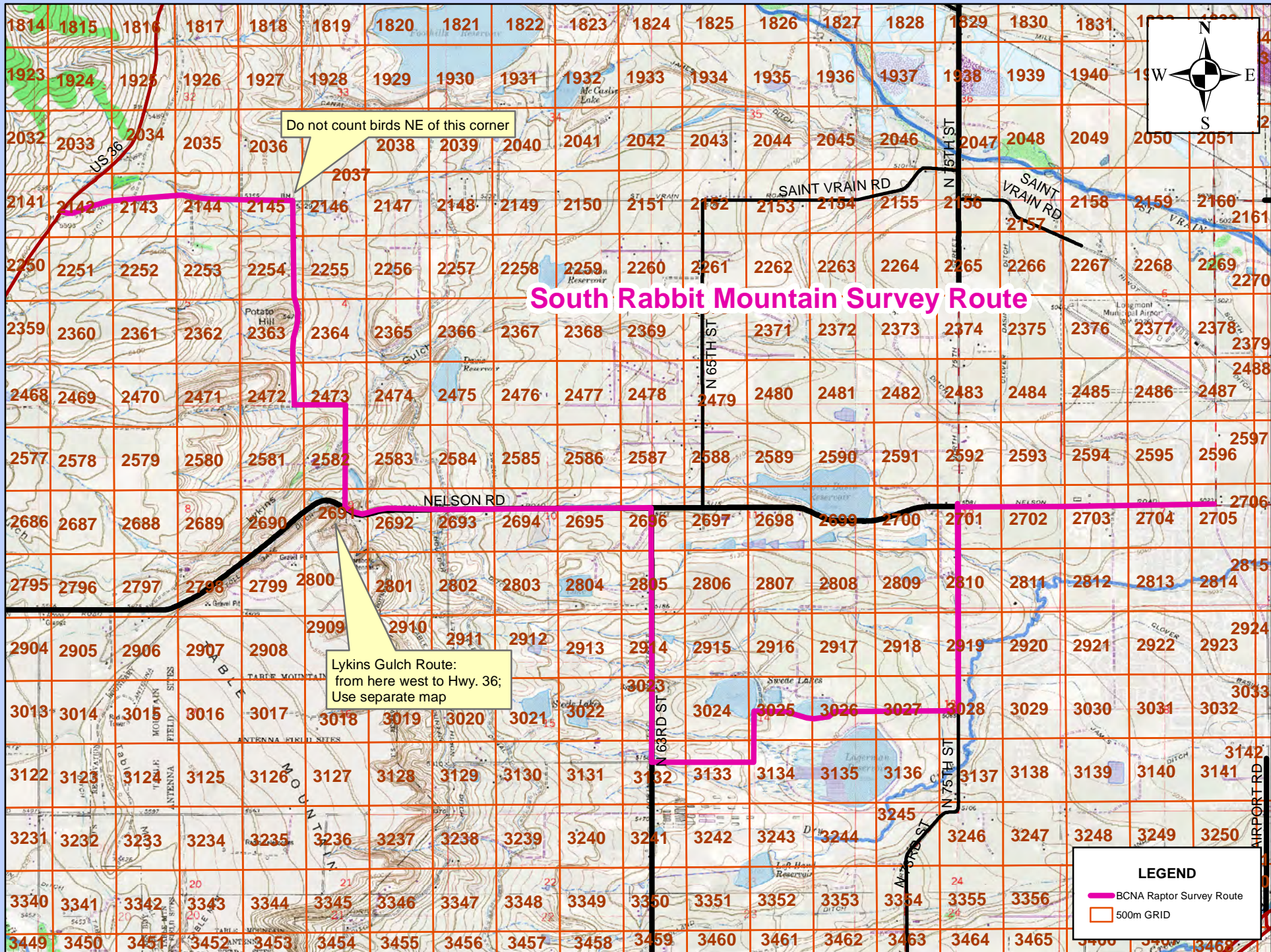

### South Rabbit Mountain Survey Route

Do not count birds NE of this corner

Lykins Gulch Route:  
from here west to Hwy. 36;  
Use separate map

**LEGEND**

- BCNA Raptor Survey Route
- 500m GRID

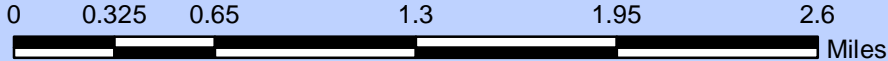

Coordinate System: NAD 1983 HARN StatePlane Colorado North FIPS 0501  
Datum: North American 1983 HARN